

Project: \_\_\_\_\_

Fixture Type: \_\_\_\_\_

Location: \_\_\_\_\_

Contact/Phone: \_\_\_\_\_

**PRODUCT SPECIFICATIONS**

**Lamp** Available with 10W or 20W G4 bi-pin halogen lamps with 2,000 hours life, 3000° Kelvin temperature and 99+ CRI  
 • **Order lamps separately** (Refer to specification sheet E5.1.0 for lamp data).

**Lamp Socket** Equipped with a patented (#5023765) swing-out socket which allows for easy relamping with no special tools required.

**Construction** Extruded aluminum with plastic end caps (#2, #3) or steel end caps (#6) • Available in custom lengths from 18" up to 144".

*Note: Total fixture wattage may not exceed 240VA (No. of lamps x lamp wattage).*

**Finishes** Available in painted White (W) or Black (B), Satin Aluminum (S), Polished Aluminum (A) or Polished Gold (G) anodized finish.

**Lens/Reflector** Supplied with clear borosilicate glass lens to shield each lamp (Lensed halogen source is a UL requirement)  
 • Frosted lens is available at additional cost) Refer to specification sheet E5.1.0 for lens options) • Reflector insert is 28 gauge Alzak® with a hammertone finish.

**Transformer** Refer to specification sheet E5.1.0 for remote and in-line transformer specifications • **Order transformer separately.**

**Labels** U.L. listed for damp locations • Union made • CSA certified.

**Testing** All reports are based on published industry procedures; field performance may differ from laboratory performance. Product specifications subject to change without notice.

**INSTALLATION**

**Application** #2 extrusion is ideal for under/over cabinets, toe-kicks, built-in furniture and coves • #3 extrusion has 45° corner which enables mounting from any of three sides for flexible aiming capability • #6 extrusion stem mounting is excellent for showcases, feature displays and wall mounting for artwork illumination.

**Mounting Hardware** #2 extrusion supplied with MC1 mounting clips • #3 extrusion supplied with MC2 mounting clips • #6 extrusion supplied with mounting stem and swivel (stem length must be specified - 6" minimum).

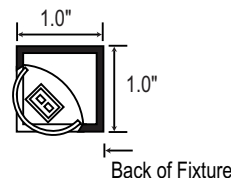
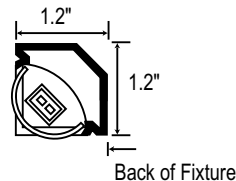
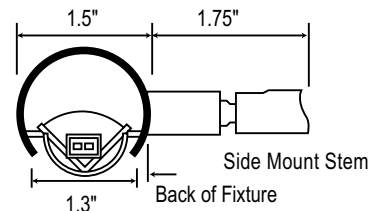
**DIMENSIONS**
**#2 SQUARE EXTRUSION**

**#3 FIVE-SIDED EXTRUSION**

**#6 CYLINDRICAL EXTRUSION**

**Electrical** #2 and #3 extrusions supplied with 1/2" flex connector (adds 1/2" to overall length for end feed) and 96" of supply wire  
 • #6 extrusion supplied with 96" of supply wire.

**ORDERING CODES** (Example: H2-73-20-9-W-RE)

H	2	73	20	9	W	RE
FIXTURE TYPE	EXTRUSION TYPE	LENGTH	LAMP WATTAGE	ON CENTER	FINISH	ELECTRICAL FEED TYPE <sup>1</sup>
Halogen	#2, #3 or #6	Specify custom lengths as required from 18" up to 144" max. ‡	20=20W 10=10W	9=9" o.c. standard, 4.5" or 6" optional*	W White B Black S Satin Aluminum A Polished Aluminum G Polished Gold	RE Right End LE Left End RB Right Back LB Left Back RF Right Front LF Left Front SMR Right Side Mount (#6 only) SML Left Side Mount (#6 only) TM Top Mount (#6 only)

\* Additional cost for 4.5" or 6.0" o.c. spacing; consult factory.

† Refer to back for illustration.

‡ Specify custom length to the nearest 1/8".

## PHOTOMETRIC REPORT

Test Report #: PR02970507 (H2, H3); PR02970505 (H6)

Luminaire: Custom Length Linear Halogen Fixture

Lamp: One 20 watt G4 bi-pin SEQ halogen lamp @ 350 lumens  
Multiplier: 10 watt - 0.4

# DANALITE

## CUSTOM LENGTH HALOGEN

10W or 20W Lamps

## H Series

### CANDELA DISTRIBUTION CURVE

#### EXTRUSION #: H2, H3

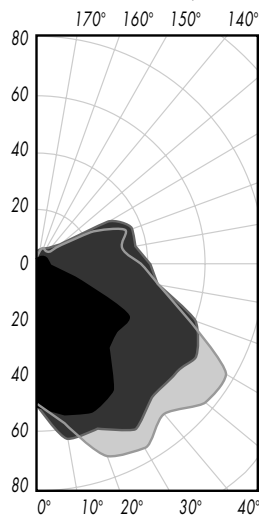

DEGREES VERTICAL	DEGREES HORIZONTAL		
	0°	45°	90°
0	51	51	51
10	59	64	54
20	73	63	56
30	76	68	53
40	70	64	40
50	77	64	38
60	78	66	39
70	57	60	16
80	44	43	3
90	37	41	0
100	30	35	0
110	33	36	0
120	22	29	0
130	6	8	0
140	2	0	0
150	0	0	0
160	0	0	0
170	0	0	0
180	0	0	0

#### EXTRUSION #: H6

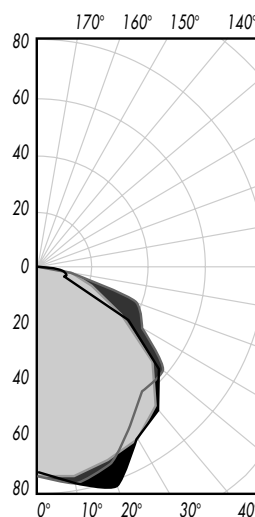

DEGREES VERTICAL	DEGREES HORIZONTAL		
	0°	45°	90°
0	74	74	74
10	76	82	78
20	73	69	81
30	71	69	71
40	66	69	68
50	55	52	57
60	35	42	39
70	21	39	11
80	13	10	10
90	4	4	4

Candlepower shown for beam side quadrant. Refer to back of specification sheet E5.1.0 for further explanation.

### ORDERING GUIDELINES

#### LENGTH & WATTAGE INFORMATION

CATALOG #*	ACTUAL LENGTH RANGE	TOTAL WATTAGE**	LAMP QTY / ON CENTER SPACING
H _____	18"-26"	40	2/9" o.c.
H _____	27"-35"	60	3/9" o.c.
H _____	36"-44"	80	4/9" o.c.
H _____	45"-53"	100	5/9" o.c.
H _____	54"-62"	120	6/9" o.c.
H _____	63"-71"	140	7/9" o.c.
H _____	72"-80"	160	8/9" o.c.
H _____	81"-89"	180	9/9" o.c.
H _____	90"-98"	200	10/9" o.c.

\* Complete catalog number as illustrated on front; please specify electrical feed type as you face the back of the fixture.

\*\* Based on 20W lamps.

#### MOUNTING HARDWARE (See E5.1.0)

**MC1** Universal mounting clips supplied with extrusion #2.  
Finishes: White or Black

**MC2** Universal mounting clips supplied with extrusion #3.  
Finishes: White or Black

**MC3** Mounting clips for glass to glass showcase applications, optional for extrusion #3.  
Finishes: White or Black

**MC4** End mounting brackets optional for extrusions #2 and #3. Right or left determined as you face the back of the fixture. Finishes: Natural Aluminum, White or Black

**MK** Canopy mounting kit with stem for extrusion #6. Finishes: White or Black

#### FEED OPTIONS

Extrusions #2 and #3 supplied with 1/2" flex connector with 96" of supply wire. Extrusion #6 supplied with mounting stem with 96" wire leads and swivel (6" minimum length on stem). Specify stem length, can be mounted with canopy kit, MK (see above). When grouping fixtures, consult factory.

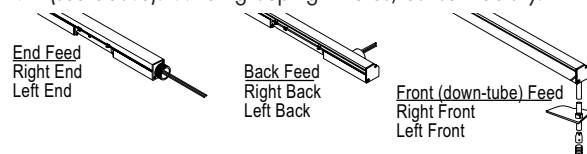

Right and left are determined as you face the back of the fixture.



1300 S. Wolf Road • Des Plaines, IL 60018 • Phone (847) 827-9880 • Fax (847) 827-2925  
220 Chrysler Drive • Brampton, Ontario • Canada L6S 6B6 • Phone (905) 792-7335 • Fax (905) 792-0064  
Visit us at [www.junolightinggroup.com](http://www.junolightinggroup.com)

Printed in U.S.A. ©2010 Juno Lighting, LLC.